

Getting Started

1. Rotate and extend the antenna.

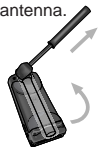

3. Insert the SIM card.

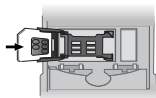

5. Remove battery's protective cover.



7. Attach battery door cover.



2. Remove battery door.



4. Push down and slide the SIM card tray to the right.

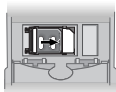

6. Install the battery by matching arrows on phone and battery.



8. Attach charging device.



9505 PORTABLE QUICK REFERENCE

Basic Operation

Turn the phone's power on/off:

Press and hold **Ⓚ**.

Place a call:

Rotate and extend the antenna in a vertical position. To dial, press: **[0+ 0 0]** or **[0 0]** and hold for two seconds, [country code], [phone number], **OK**.



Answer a call (with antenna rotated and extended):

Phone rings and/or vibrates

After Call followed by Answer? is in display, press **OK**.

Answer a call (with antenna stowed):

Phone chirps

Rotate and extend antenna

Phone will ring and/or vibrate

After Call followed by Answer? is in display, press **OK**.

End a call:

Press **Ⓚ**.

Special Features

Adjust earpiece volume:

Press upper and lower volume keys on the side of the phone.

Adjust ringer volume:

Press **↑** and then the upper and lower volume keys on the side of the phone.

Clear the last digit in the display or exit a submenu:

Press **Ⓚ**.

Clear the entire display or exit the menu system:

Press and hold **Ⓚ**.

Select prompt language:

Press and hold **Ⓚ** to return to idle display.

Press **2**, **6**, or **OK** to go to the language selection submenu.

Press **OK** until you see the preferred language.

Press **OK** to select.

Special Features Continued

Keypad disable:

Press ***** and **#** keys simultaneously to prevent accidental usage of the phone. All keys with the exception of the **Ⓚ** key will be disabled. You can still answer an incoming call by pressing **OK** when the keypad is locked. To remove the keypad disable, press ***** and **#** simultaneously.

Display your phone number:

Press **MI** **#**.

Also refer to the "View Your SIM Card Phone Number(s)" section of the User's Guide.

Quick Access Menu

Factory default for satellite and cellular mode.

- | | | |
|----------|----------------|-------------------------|
| ↑ | | 6 Vibrate On/Off |
| 1 | Find Name | 7 Read Messages |
| 2 | Mute | 8 Register Now |
| 3 | Call Voicemail | 9 Forward On/Off |
| 4 | Battery Meter | |
| 5 | Lock Now | |

Phone Book

Recall a number from the phone book:

1. Press **MI**.
2. Enter the one-, two-, or three-digit location number of the entry, and then press **OK**.
3. Press **OK** to call the displayed entry.

Recall last ten numbers dialed:

1. Press **MI** until you see Phone Book, and then press **OK**.
2. Press **MI** to scroll to Last Ten Calls, and then press **OK** to select.
3. Press **MI** to scroll to Last Calls Made and then press **OK** to select.
4. Press **MI** to scroll to the number you are looking for.
5. Press **OK** to place a call to that number.